

INSERT THE FIXTURE IN CUTTED
FALSE CEILING AND ROTATE THE
WINGS

FIX

PLASTER

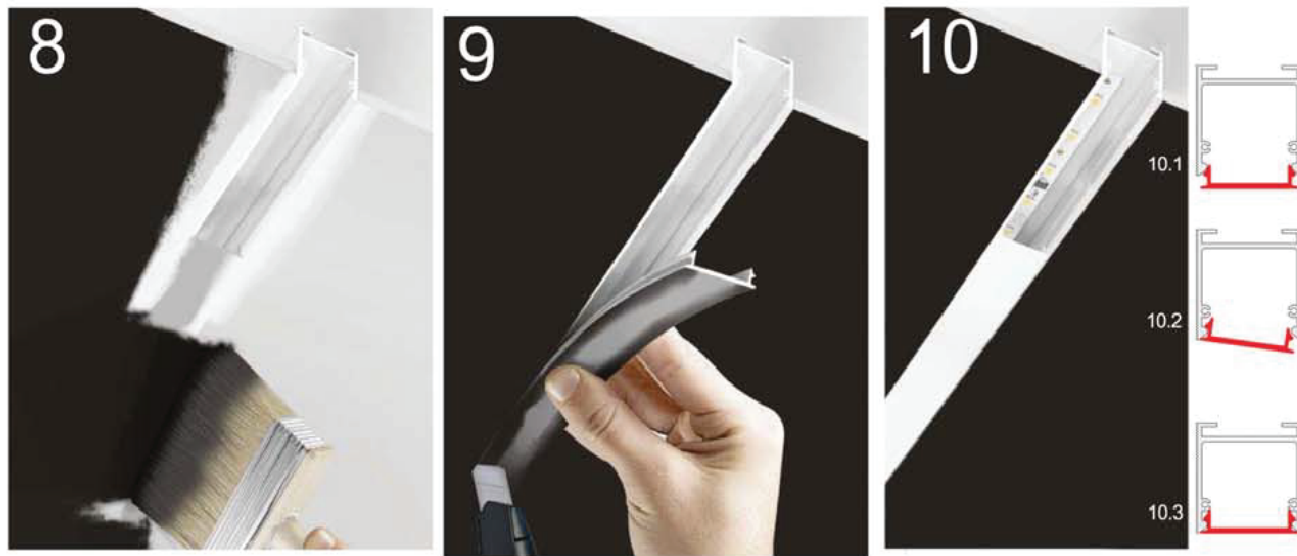

PAINT

REMOVE THE DISPOSABLE
SCREEN WITH THE HELP OF
“CUTTER” TO AVOID DAMAGING
TO THE PAINT

FIX LED AND POLYCARBONATE
SCREEN

Application Examples

Attention !
Observe the polarity, install in parallel

Linear Junction
D8-6338

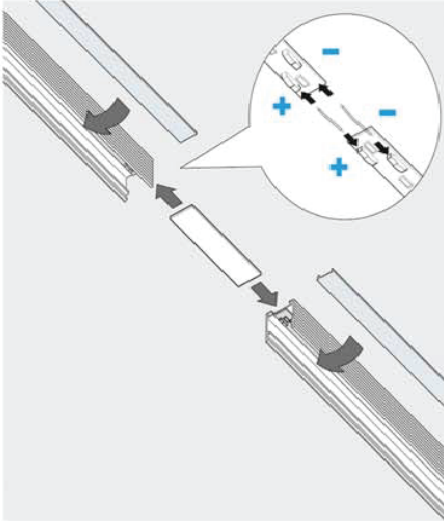

90° wall to ceiling Junction
D8-6337

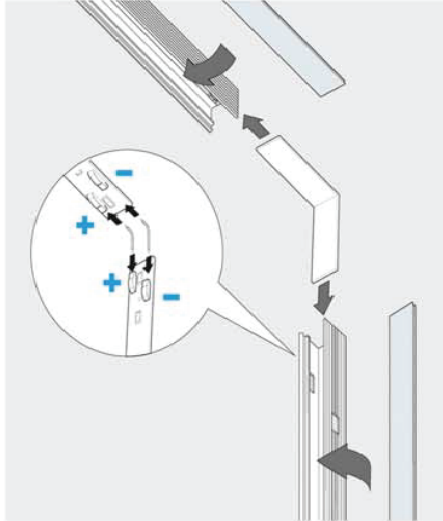

T Junction trimless
D8-6340

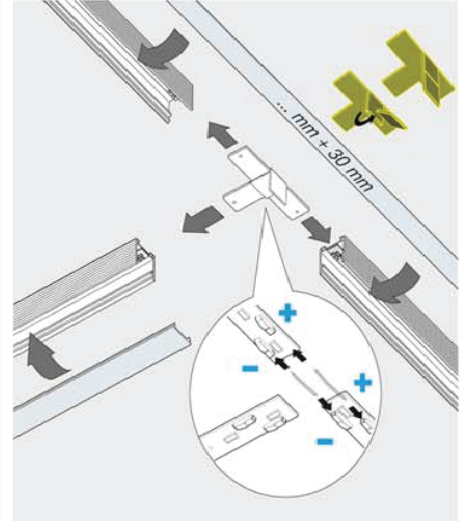

90° wall to wall / ceiling to ceiling Junction
D8-6339

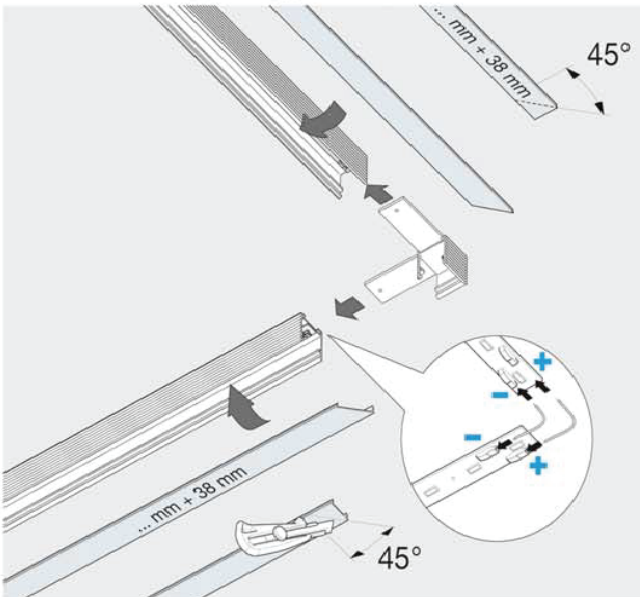

X Junction trimless
D8-6341

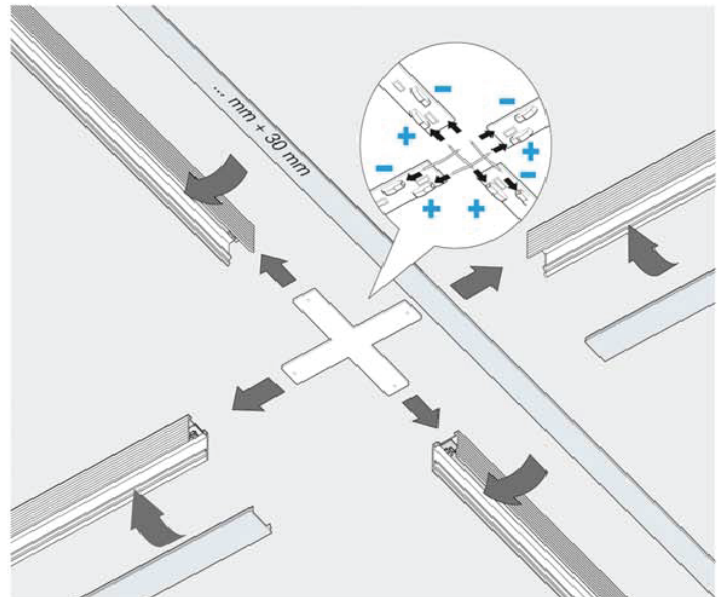



GENERAL INFORMATION

Caution: when installing, pay attention to the arrangement of the support structure of the plasterboard in order to facilitate the realization of holes for the lighting fixtures. The unit must not under any circumstances be covered by insulating material or similar.

Install in non-insulated ceiling only.

INSTALLATION

Drill the hole in the plasterboard according to the following measurements:

MODEL	ARTICLE	SIZE mm
D8 - 6324	50 TRACK	515X40
D8 - 6325	100 TRACK	1015X40
D8 - 6326	200 TRACK	2015X40
D8 - 6327	300 TRACK	3015X40

- Obtain the correct power supply unit(accessory not included), install it in a remote location and prepare the cables for their connection
- Mount the wings on the device following the instructions provided in figures 1,2,3,4
- Insert the unit into the hole in the drywall with the wings positioned as shown in Figure 4
- Rotate the wings A (figure 5) and fix the appliance to the plasterboard with the screws B (figure 6)
- By turning the screws C (figure 6) position the unit at the appropriate level
- Insert the disposable screen for scrapings, plaster (figure 7) and paint (figure 8)
- Remove the disposable screen (figure 9)
- Install the LEDs (PAYING ATTENTION TO OBSERVE POLARITY, parallel connection), connect to the power supply and insert the polycarbonate screen (figure 10)

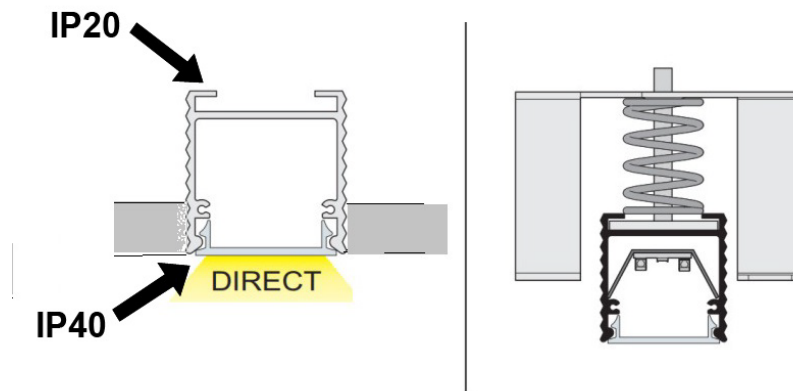

Post Sales Support

HQ 1-800-388-3382 support@zaneen.com



EN

- Installation and electrification must be carried out by a qualified electrician, only.
- Observe all relevant building codes and regulations.
- Prior to installation or repair: disconnect power; it is the installer's responsibility to ensure for all electrical, mechanical and thermal compatibility.
- The LED light source contained in this fixture shall only be replaced by Zaneen, or a person approved by Zaneen.
- Recommendations: Keep the instruction sheet(s) in the event of maintenance and/or disassembly.

Access detailed spec sheets from www.zaneen.com

FR

- L'installation et l'électrification doivent être effectuées uniquement par un électricien qualifié.
- Respectez tous les codes du bâtiment et réglementations en vigueur.
- Avant l'installation ou la réparation: débranchez l'alimentation électrique; Il incombe à l'installateur des'assurer de la compatibilité électrique, mécanique et thermique.
- La source de lumière LED contenue dans ce luminaire ne doit être remplacée que par Zaneen, ou une personne approuvée par Zaneen.
- Recommandations: Conservez la (les) fiche (s) d'instructions en cas de maintenance et / ou de démontage

Accéder aux fiches techniques détaillées sur www.zaneen.com