

D8-3327 or D8-3348 LED 11W 120V



OPERATION AND USE INSTRUCTIONS

ATTENTION: PLEASE READ AND SAVE THESE INSTRUCTIONS

The safety of this fitting is only guaranteed if the instructions are followed carefully. Installation and all non-routine maintenance must be carried out only by qualified personal.

Disconnect before taking any action on the fitting.

Zaneen is not responsible for any damage to persons and/or property resulting from improper installation, misuse, or unauthorized modifications made to their products.

- This fixture can be installed in 4 different positions.

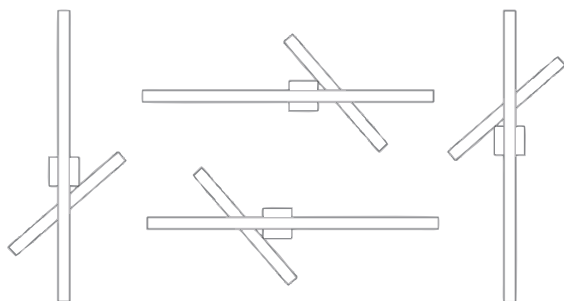

FIGURE A:

- Unscrew the two screws and open the cross bar with the driver attached

FIGURE B:

1- Make the connections according to the color code to the driver.

2- Connect the cross bar using 2 screws provided.

3- Mount back the fixture on the cross bar using the two screws opened in Figure A.

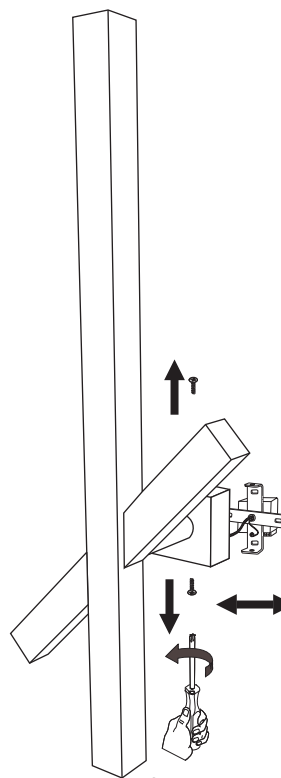

Open two screws to release the cross bar with the driver attached to it.

FIG. A

FIG. B

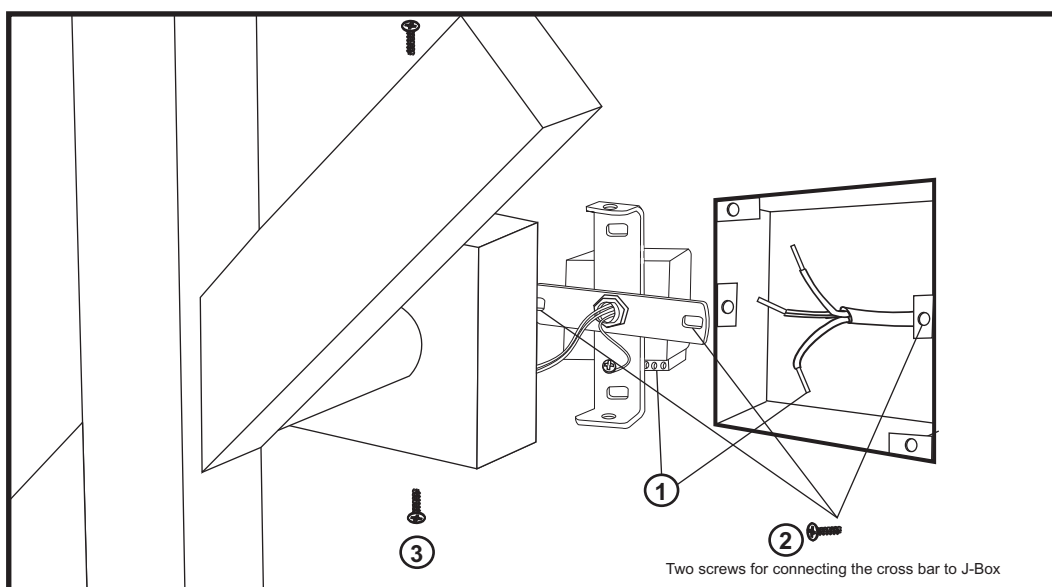

The device may not be disposed of with household rubbish. This appliances is labelled in accordance with European Directive 2002/96/EG concerning used electrical and electronic appliances (waste electrical and electronic equipment – WEEE). The guideline determines the framework for the return and recycling of used appliances as applicable throughout the EU. To return your used device, please use the return and collection systems available to you.



Approved by CSA for CANADIAN & US Safety Standard.

MAINTENANCE

Only clean the product using a soft cloth. To remove persistent marks use only a damp cloth and neutral soap

DON'T USE alcohol and/or solvent

Fixtures with led: the led cannot be partially replaced. If damaged all the power supply must be replaced.