

FLAMINGO 2.0 WALL SURFACE
INSTALLATION GUIDE

ZANEEN®

Certified for
North
American
Standards

IP65



TECHNICAL INFORMATION

FLAMINGO 2.0 Wall IP65 

Risk group (EN 62471:2008)

	Class	Power supply
9W Led		120V 50/60Hz

FLAMINGO 2.0 Wall 850

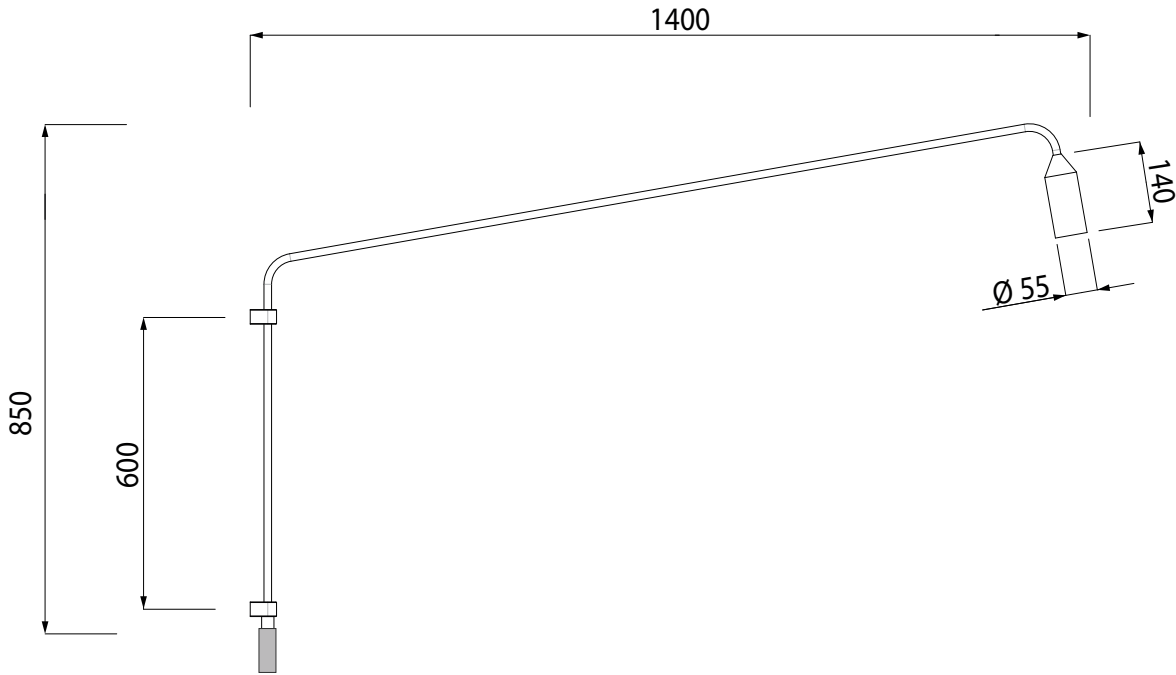

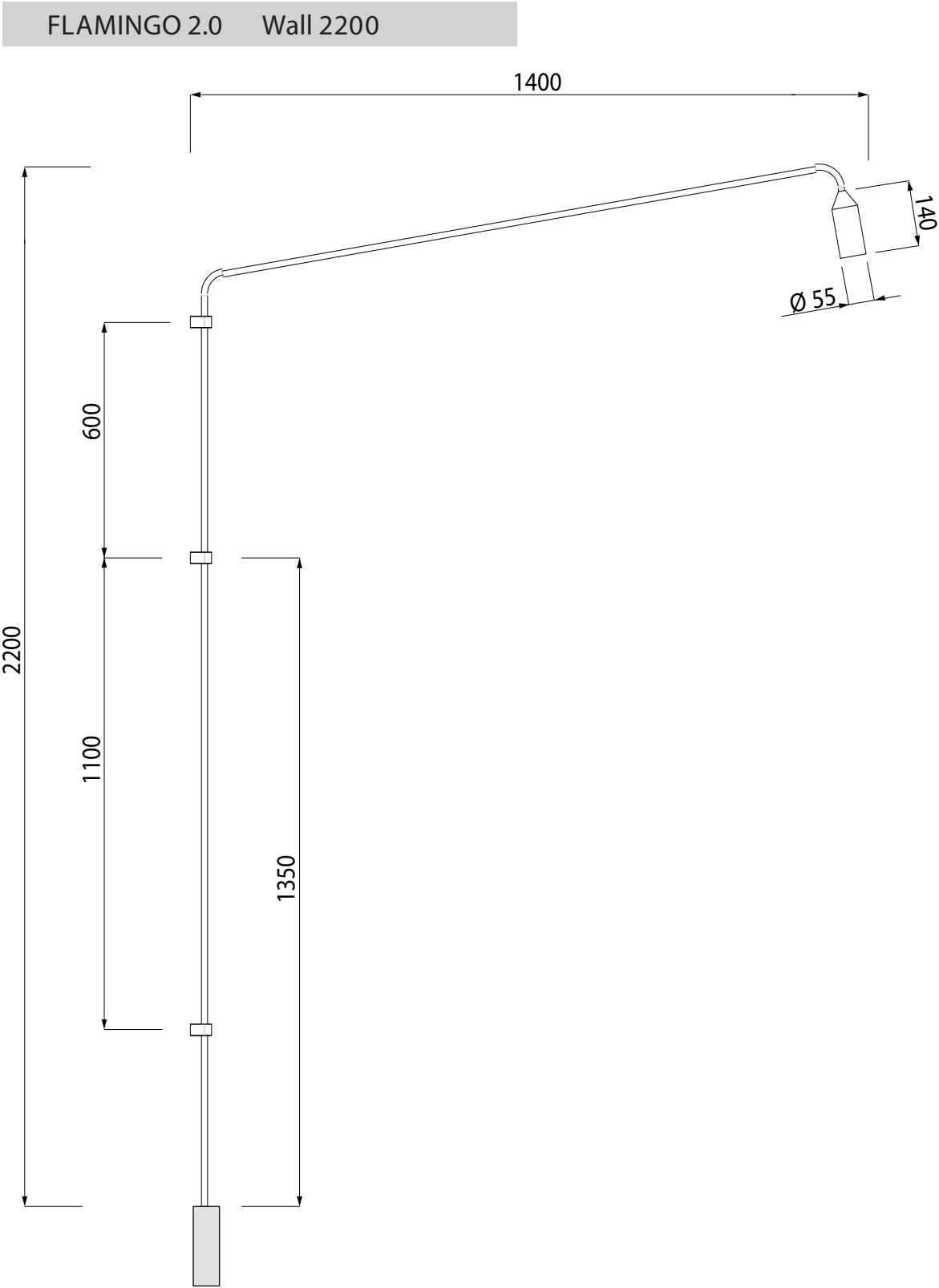

FLAMINGO 2.0 Wall 850 / 2200

INSTALLATION



Driver
Enclosure

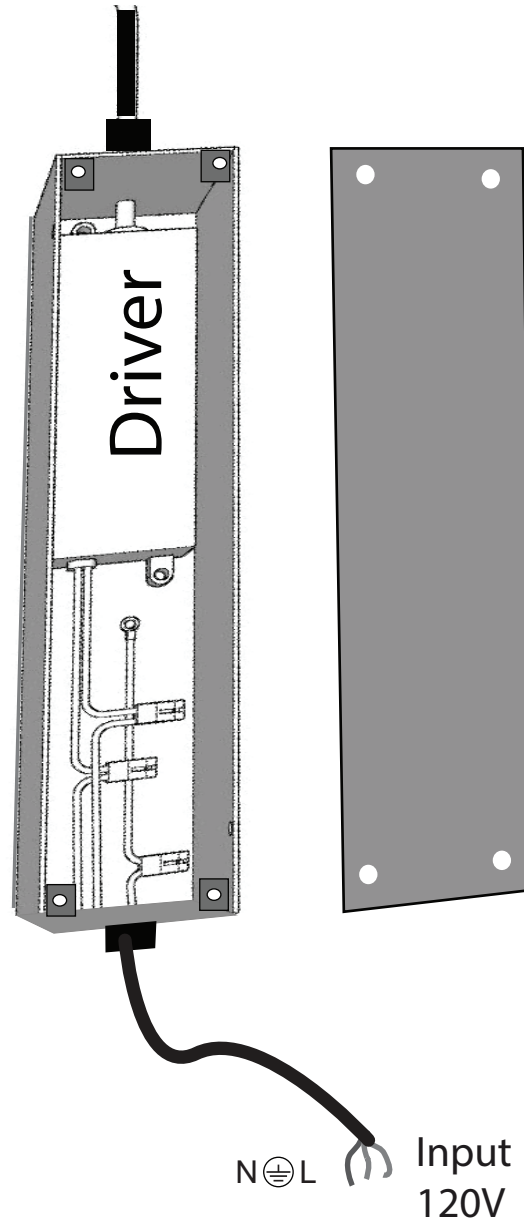

FLAMINGO 2.0 Wall 850 / 2200

INSTALLATION

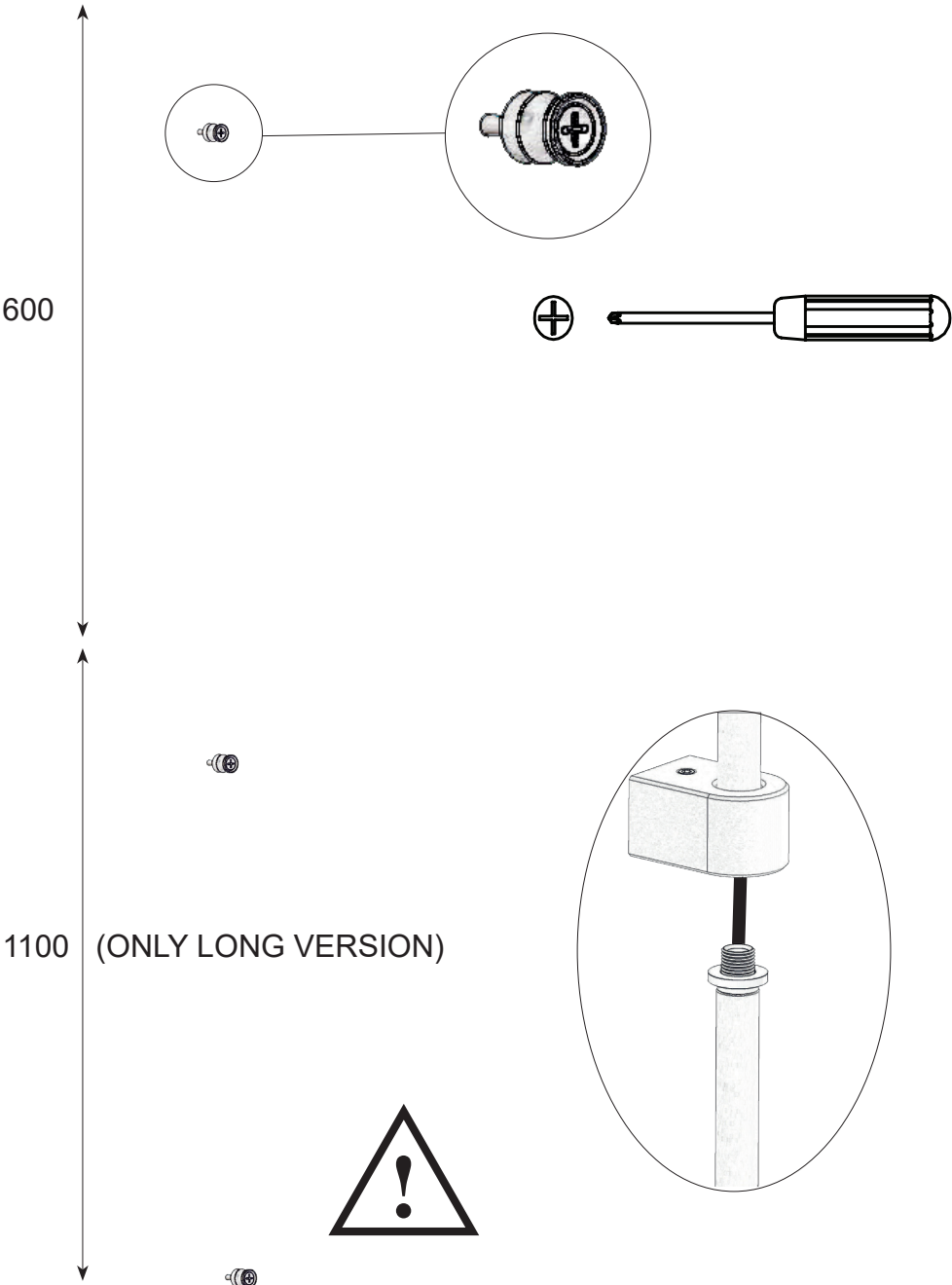

FLAMINGO 2.0 Wall 850 / 2200 INSTALLATION

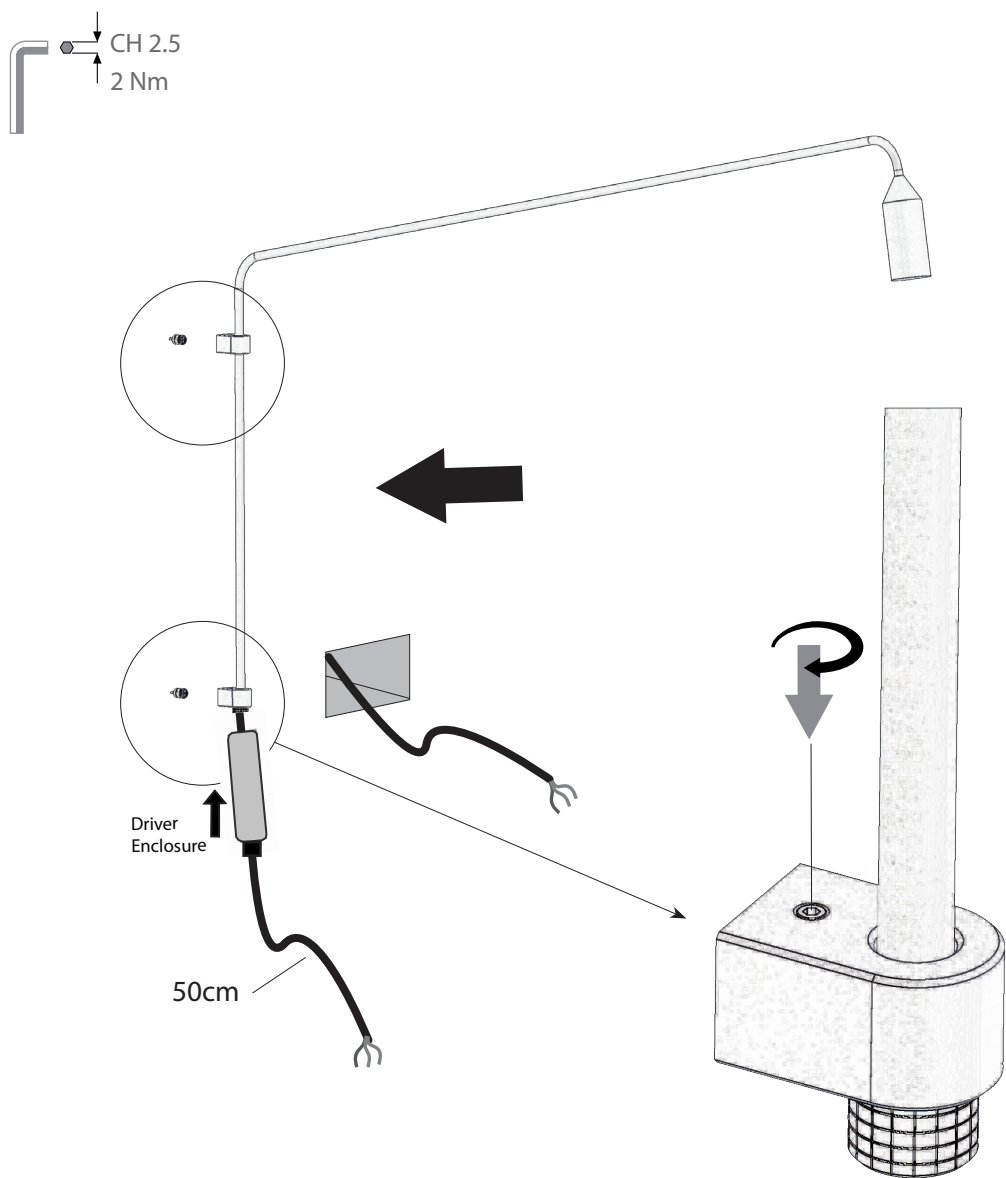

FLAMINGO 2.0 Wall 850 / 2200

Electric connection

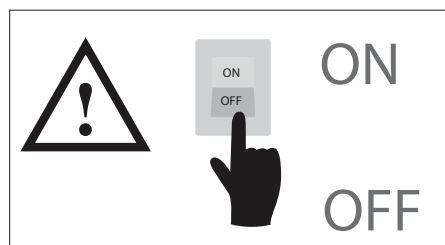
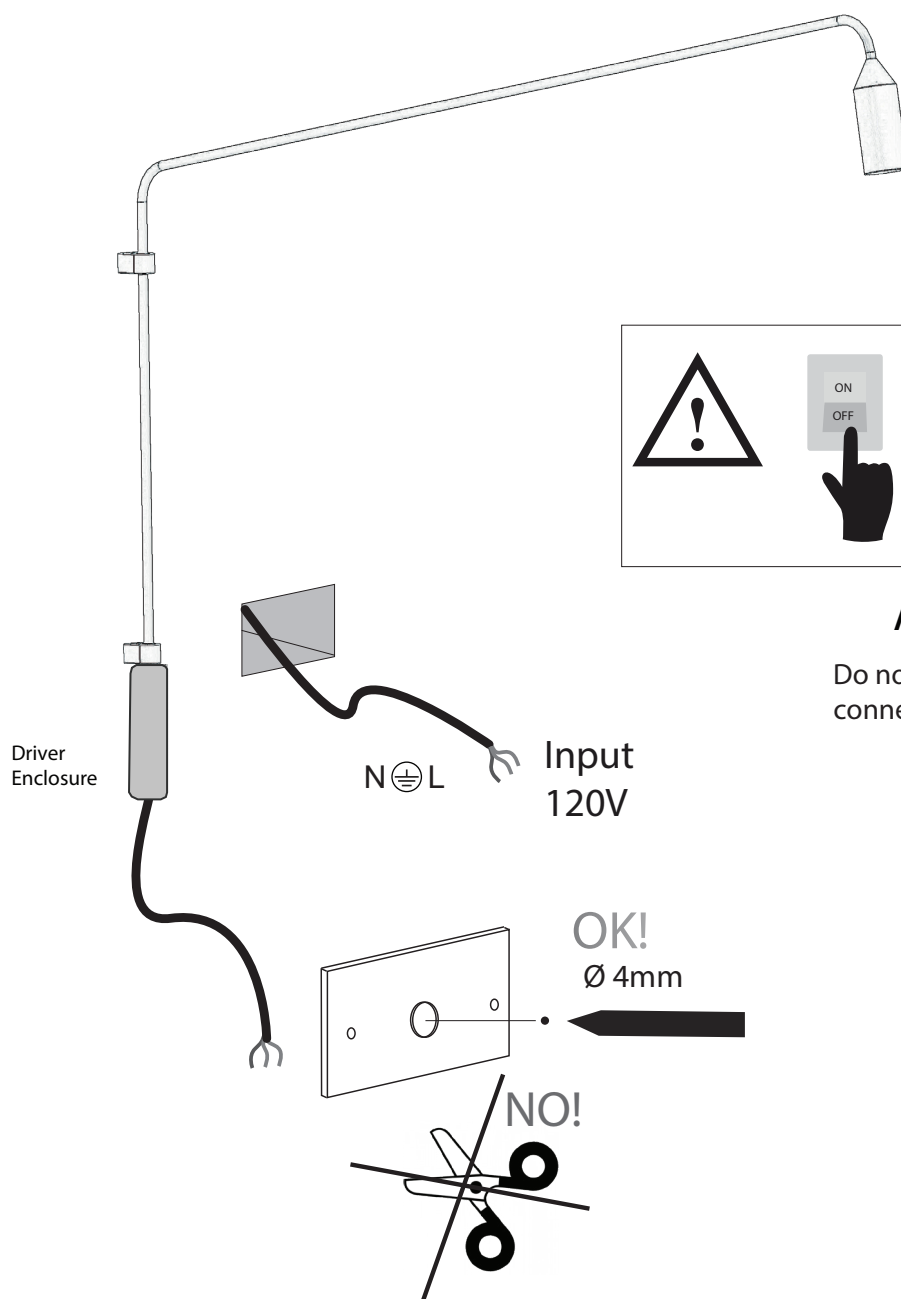

Attention !

Do not plug in or unplug the connector when power is on!

FLAMINGO 2.0 Wall 850 / 2200

INSTALLATION

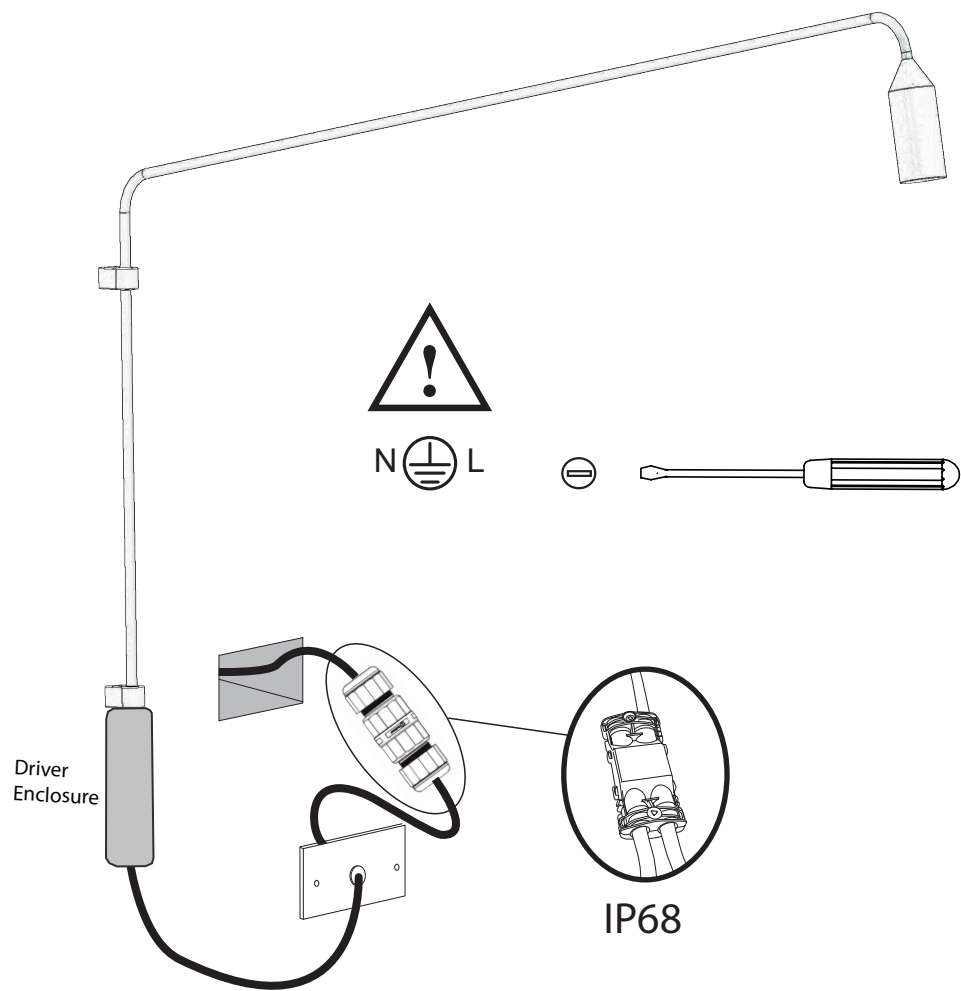

Connector supplied by others

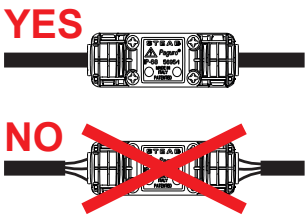

FLAMINGO 2.0 Wall 850 / 2200 INSTALLATION

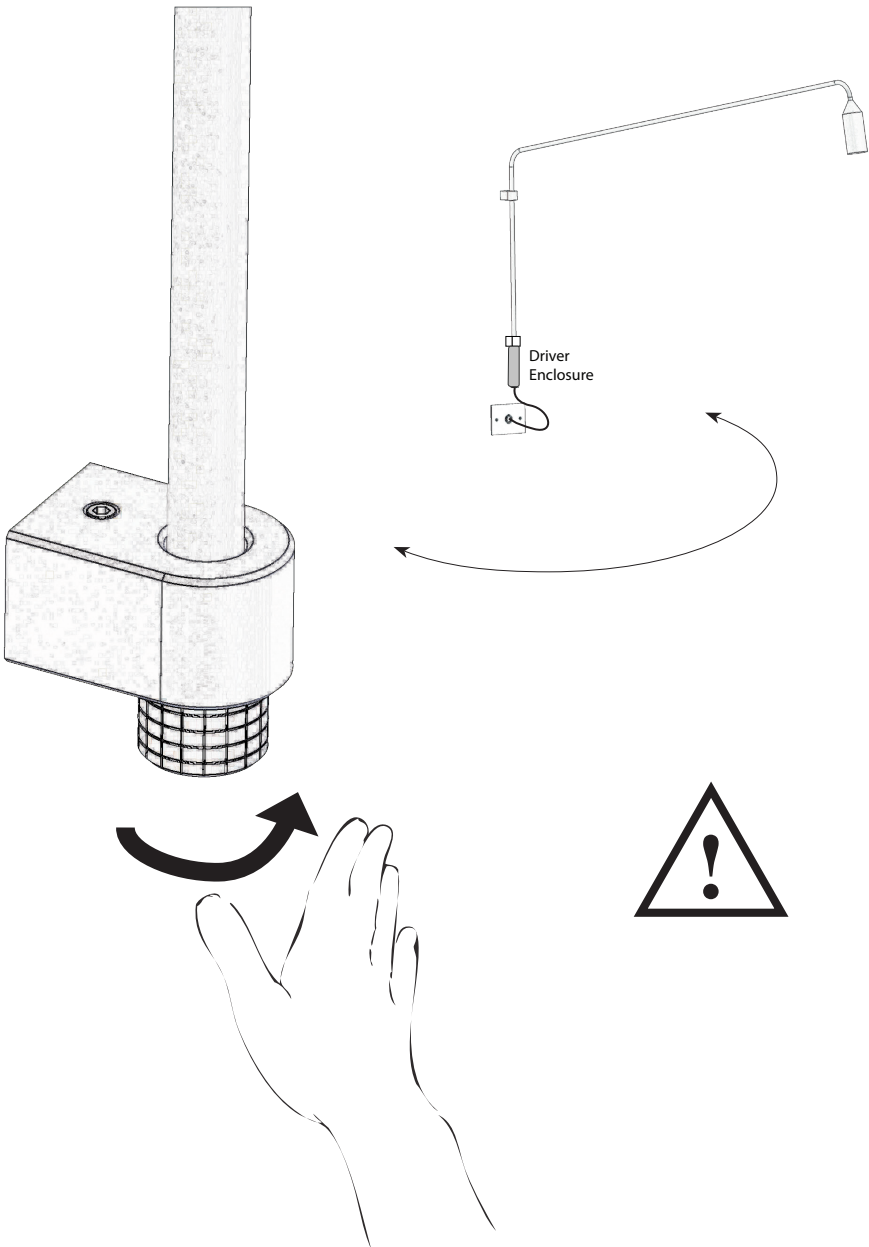

SAFETY AND WARNINGS

Safety and warnings for installation:

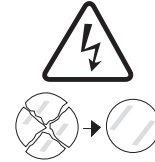

- Installation and start-up must be carried out by qualified personnel only.
- Carry out operations on device only with device disconnected from power supply.
- Connect to mains following the installation regulations in force.
- Keep installation instructions in the event of maintenance or disassembly operations, or make them available for the personnel in charge.
- Replace lamp only when the device has cooled down and is not powered.
- Use the device only with a complete glass.

LED MODUL

CAUTION: Make sure that the lines are protected from over-voltage.



Do not look into the beam. LED-Module Class 1.
In case of malfunctions with the LED module, please contact Zaneen



We do not recommend switching on the fitting during the day with strong solar radiation.



IMPORTANT

Post Sales Support HQ 1-800-388-3382 support@zaneen.com



EN

- Installation and electrification must be carried out by a qualified electrician, only.
- Observe all relevant building codes and regulations.
- Prior to installation or repair: disconnect power; it is the installer's responsibility to ensure for all electrical, mechanical and thermal compatibility.
- The LED light source contained in this fixture shall only be replaced by Zaneen, or a person approved by Zaneen.
- Recommendations: Keep the instruction sheet(s) in the event of maintenance and/or disassembly.

Access detailed specification sheets and the warranty policy on the product page at zaneen.com.

FR

- L'installation et l'électrification doivent être effectuées uniquement par un électricien qualifié.
- Respectez tous les codes du bâtiment et réglementations en vigueur.
- Avant l'installation ou la réparation: débranchez l'alimentation électrique; Il incombe à l'installateur des'assurer de la compatibilité électrique, mécanique et thermique.
- La source de lumière LED contenue dans ce luminaire ne doit être remplacée que par Zaneen, ou une personne approuvée par Zaneen.
- Recommandations: Conservez la (les) fiche (s) d'instructions en cas de maintenance et / ou de démontage

Accéder aux fiches techniques détaillées et à la politique de garantie sur la page du produit sur zaneen.com