

Example:  
canopy version IP20

Example:  
plug version IP65

D81432

## RALPH

### INSTALLATION AND USER INSTRUCTIONS

#### ATTENTION: PLEASE READ AND SAVE THESE INSTRUCTIONS

The safety of this fitting is only guaranteed if the instructions are followed carefully.

Installation and all non-routine maintenance must be carried out only by qualified personal.

Disconnect before taking any action on the fitting.

Zaneen is not responsible for any damage to persons and/or property resulting from improper installation, misuse, or unauthorized modifications made to their products.

### MODEL

D81432 max 53W E27 IP65\*  
max 23W Micro Twist E27 IP65\*



\* Only plug version

### LAMP ASSEMBLY DIAGRAM

-Attach bracket (1) to the wall  
-Open the terminal (2) and connect the cables from the mains inserted through the rubber cap (3)

-Connect the ground wire to the terminal (X)

-Close the terminal (2) and secure the lamp to the bracket (1)

Insert the bulb (A)

Insert the lamp shade (B) on the polycarbonate shell (C) making sure the three hooks (D) are attached correctly.

-Insert the polycarbonate cover (C) on the mounting (E) and tighten until the orange sticker (F) of the polycarbonate cover coincides with the dent (G) on the mount.

### MAINTENANCE

We recommend using only a soft cloth when cleaning the device. In case of stubborn dirt, dampen the cloth, and use neutral soap if necessary. DO NOT use alcohol and/or solvents.

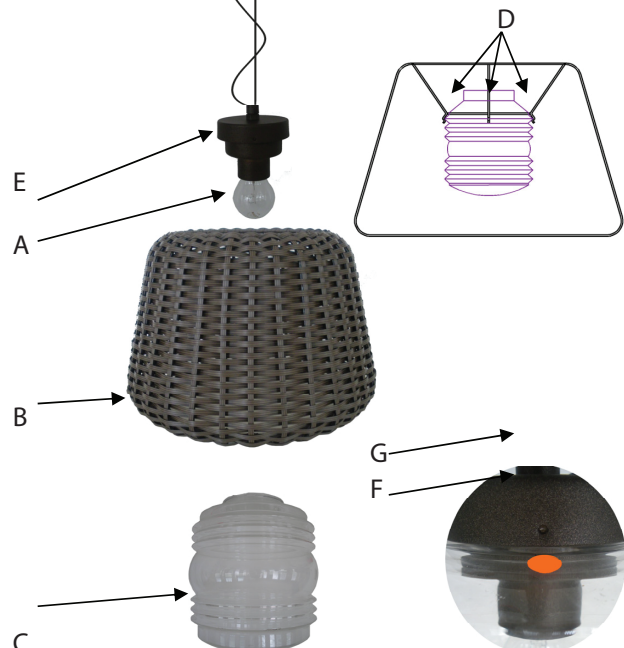
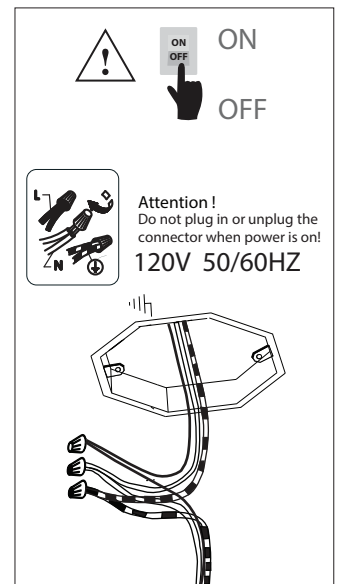
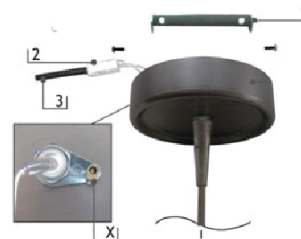
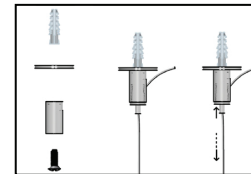

### IP..

Protection Index  
The protection rating of the lighting appliances is shown by the letters IP followed by two characteristic digits. The first of these two digits indicates the degree of protection that the appliances offer against the entry of solid foreign objects. The second one indicates the protection against the entry of water.



Class II fixture A fixture for which protection against an electric shock does not rely on basic insulation but also offers further safety measures, such as double insulation or reinforced insulation. These measures do not require grounding devices and are not dependent upon installation conditions.



The device may not be disposed of with household rubbish. This appliance is labelled in accordance with European Directive 2002/96/EG concerning used electrical and electronic appliances (waste electrical and electronic equipment - WEEE). The guideline determines the framework for the return and recycling of used appliances as applicable throughout the EU. To return your used device, please use the return and collection system available to you.

**IMPORTANT**

Post Sales Support   HQ 1-800-388-3382   [support@zaneen.com](mailto:support@zaneen.com)



**EN**

- Installation and electrification must be carried out by a qualified electrician, only.
- Observe all relevant building codes and regulations.
- Prior to installation or repair: disconnect power; it is the installer's responsibility to ensure for all electrical, mechanical and thermal compatibility.
- The LED light source contained in this fixture shall only be replaced by Zaneen, or a person approved by Zaneen.
- Recommendations: Keep the instruction sheet(s) in the event of maintenance and/or disassembly.

Access detailed specification sheets and the warranty policy on the product page at [zaneen.com](http://zaneen.com).

**FR**

- L'installation et l'électrification doivent être effectuées uniquement par un électricien qualifié.
- Respectez tous les codes du bâtiment et réglementations en vigueur.
- Avant l'installation ou la réparation: débranchez l'alimentation électrique; Il incombe à l'installateur des'assurer de la compatibilité électrique, mécanique et thermique.
- La source de lumière LED contenue dans ce luminaire ne doit être remplacée que par Zaneen, ou une personne approuvée par Zaneen.
- Recommandations: Conservez la (les) fiche (s) d'instructions en cas de maintenance et / ou de démontage

Accéder aux fiches techniques détaillées et à la politique de garantie sur la page du produit sur [zaneen.com](http://zaneen.com)